

# AUFWALZ AUGTERMINAL

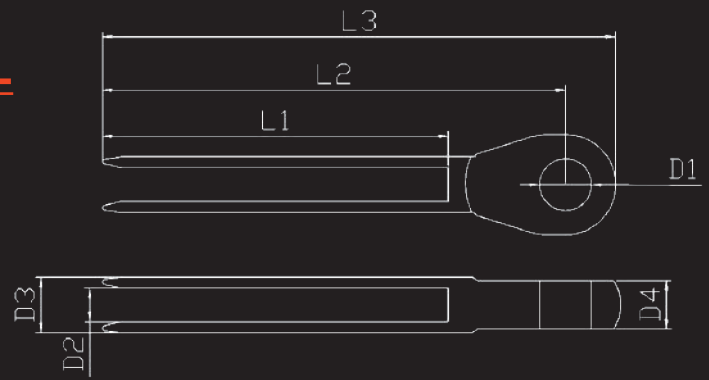

Verbindet den Edelstahlbraht durch Walzen oder Pressen permanent mit dem Terminal.  
Nur mit geeigneten Walzmaschinen von erfahrenen Anwendern zu verarbeiten.

*Connects wire and terminal permanently via pressing or swaging.*

*Requires suitable swaging machine used by skilled persons.*

Product	L1	L2	D1	D2	D3	D4	BL	MWL	Weight	Wire
7TT190006	63 mm	92 mm	11 mm	6.5-6.7 mm	12.4-12.6mm	12 mm	4050 daN	2020 daN	94 g	max 6 mm
7TT190007	72 mm	103 mm	13 mm	7.2-7.5 mm	13.8-14.0mm	12 mm	5600 daN	2800 daN	120 g	max 7 mm
7TT190008	85 mm	124 mm	14 mm	8.3-8.5 mm	15.8-16.0mm	13 mm	8300 daN	4200 daN	173 g	max 8 mm
7TT190010	90 mm	146 mm	16 mm	10.4-12.7mm	17.7-17.9mm	15 mm	9300 daN	4700 daN	260 g	max 10 mm
7TT190012	118 mm	166 mm	19 mm	12.4-12.7mm	14.8-15.0mm	17 mm	13800 daN	6900 daN	410 g	max 12 mm
7TT190014	155 mm	207 mm	23 mm	14.8-15.0mm	24.7-25.0mm	22.5 mm	18450 daN	9300 daN	730 g	max 14 mm
7TT190016	180 mm	245 mm	25 mm	16.5-16.8mm	27.8-28.2mm	25.0 mm	30000 daN	15000 daN	2100 g	max 16 mm

# AUFWALZ GABELTERMINAL

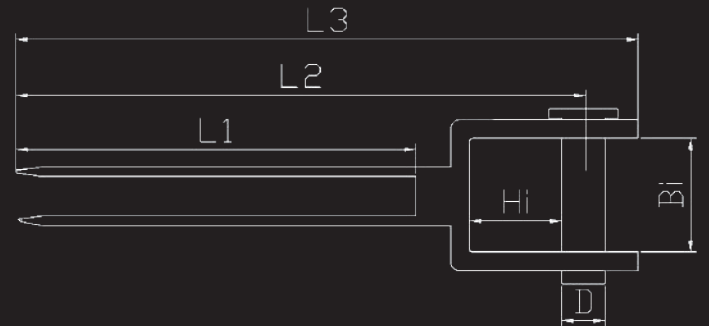

Product	L1	L2	L3	HI	BI	D	BL	MWL	Weight	Wire
7TT100006	63 mm	120 mm	130 mm	22 mm	22 mm	11 mm	4050 daN	2020 daN	100 g	max 6 mm
7TT100007	72 mm	120 mm	135 mm	22 mm	15 mm	13 mm	5600 daN	2800 daN	170 g	max 7 mm
7TT100008	85 mm	140 mm	155 mm	24 mm	20 mm	14 mm	8300 daN	4200 daN	340 g	max 8 mm
7TT100010	90 mm	160 mm	180 mm	26 mm	20 mm	16 mm	9300 daN	4700 daN	530 g	max 10 mm
7TT100012	118 mm	200 mm	230 mm	28 mm	26 mm	19 mm	13800 daN	6900 daN	800 g	max 12 mm